

# BC01 Series



## Features :

- Efficiency Up to 81%
- Miniature Package
- I/O Isolation 1000VDC
- SMT Technology
- Low Cost



## Model List

Model Number	Input Voltage (VDC)	Output Voltage (VDC)	Output Current (mA)	Efficiency @ Max. Load % (Typ.)
BC01-05S3V3	4.5~5.5	3.3	260	73
BC01-05S05V		5	200	76
BC01-05S12V		12	85	79
BC01-05S15V		15	65	80
BC01-05D05V		±5	±100	76
BC01-05D12V		±12	±45	80
BC01-05D15V		±15	±35	80
BC01-12S3V3	10.8~13.2	3.3	260	74
BC01-12S05V		5	200	79
BC01-12S12V		12	85	80
BC01-12S15V		15	65	80
BC01-12D05V		±5	±100	80
BC01-12D12V		±12	±45	81
BC01-12D15V		±15	±35	81
BC01-24S3V3	21.6~26.4	3.3	260	73
BC01-24S05V		5	200	76
BC01-24S12V		12	85	79
BC01-24S15V		15	65	80
BC01-24D05V		±5	±100	76
BC01-24D12V		±12	±45	79
BC01-24D15V		±15	±35	80

V1.0.0 2013

## Input Specifications

Input Filter		Pi Type
Surge Voltage (100 ms max.)	5V <sub>in</sub> Models:	9V max.
	12V <sub>in</sub> Models:	18V max.
	24V <sub>in</sub> Models:	30V max.

## Output Specifications

Output Power		1W max.
Voltage Set Accuracy		±3%
Line Regulation (Low Line, High Line at Full Load)		±1.5%
Load Regulation (0% to 100% Full Load)	Single:	±10%
	Dual:	±10%
Ripple and Noise (20MHz Bandwidth)	3.3, 5VDC Models:	100mV <sub>pk-pk</sub> max.
	Others Models:	1%V <sub>outpk-pk</sub> max.
Minimum Load		0%

## Environmental Specifications

Operating Temperature Range (Ambient)		-25°C to +70°C (with Derating)
Maximum Case Temperature		+90°C
Storage Temperature Range		-40°C to +125°C
Cooling		Free-air Convection
Temperature Coefficient		±0.05%/°C max.
Humidity		95%

## General Specifications

Over Load Protection (% of Full Load at Nominal V <sub>in</sub> )		>110% typ.
MTBF(MIL-HDBK-217F, at +25°C, Ground Benign)		>15×10 <sup>3</sup> Hours
Isolation Voltage (60 sec.)	Input/Output:	1000VDC
Isolation Resistance	Input/Output(500VDC):	>1000Mohm
Switching Frequency (Fixed)		100kHz typ. (Pulse Width Modulation PWM)

## Derating Graph

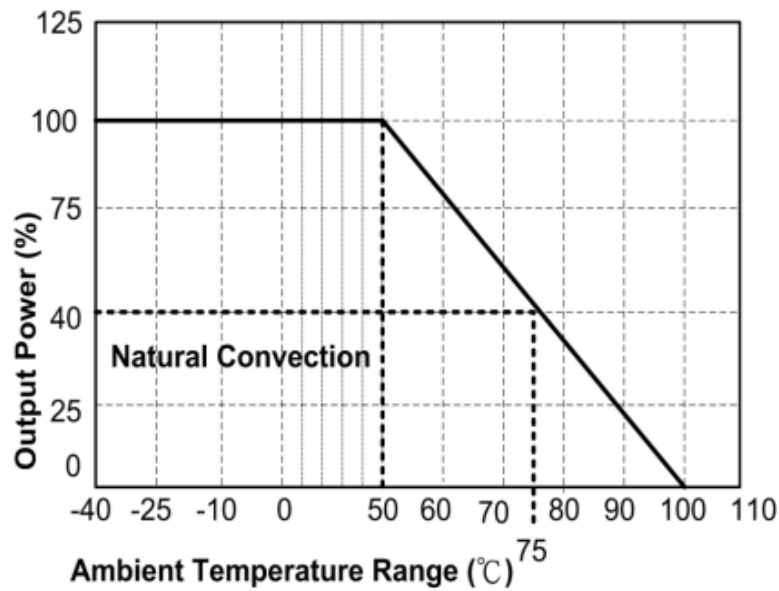

If you need more detailed information,  
please contact us via email at [sales@mail.longsun.tw](mailto:sales@mail.longsun.tw)

## Physical Specifications

Case Material	Non-Conductive Black Plastic
Potting	Flammability to UL94V-0
Dimension	0.77"x0.24"x0.4"
Weight	3g(0.11oz)
Soldering Temperature	max. 260°C/10s
Environmental Compliance Certification	Reach RoHS

## Outline Dimensions

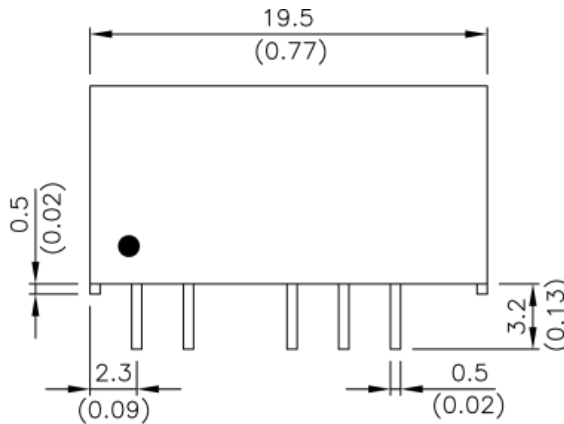

Pin Connections		
Pin	Single	Dual
1	+Vin	+Vin
2	-Vin	-Vin
4	-Vout	-Vout
5	No Pin	Common
6	+Vout	+Vout

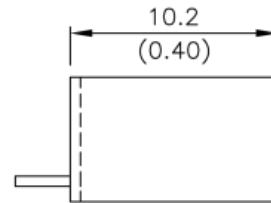
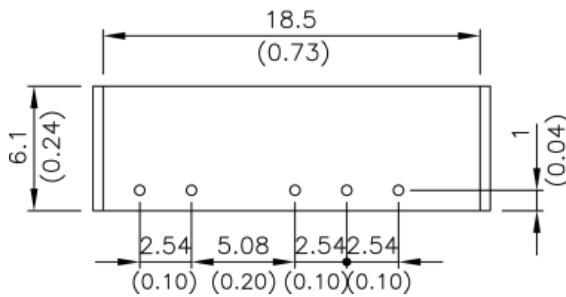

Dimensions in [mm], ( ) = Inch

## Notes

1. All specifications are typical at  $T_a=25^{\circ}\text{C}$ , nominal input voltage, resistive load and rated output current unless otherwise noted.
2. All specifications are subject to change without notice.
3. Typical value is measured at nominal input voltage and no load.
4. Maximum value is measured at nominal input voltage and full load.
5. Typical value is measured at nominal input voltage and full load.